

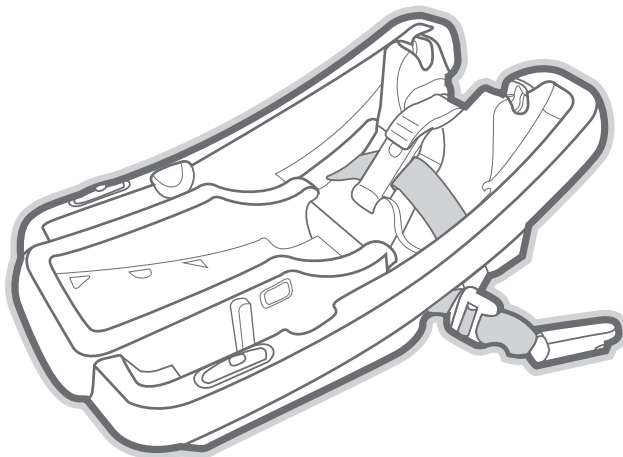

baby
jogger®

city GO™ base



PD349577C 

KEEP INSTRUCTIONS FOR FUTURE USE

Do not install or use this child restraint base until you read, understand and follow the instructions in this manual and the warnings on the base.
FAILURE TO PROPERLY USE THIS CHILD RESTRAINT BASE INCREASES THE RISK OF SERIOUS INJURY OR DEATH IN A SUDDEN STOP OR CRASH.

babyjogger.ca

TABLE OF CONTENTS

Registration.....	3
Warnings.....	5
UAS System.....	7
Vehicle Seat Locations.....	8
Features.....	12
Adjusting the Recline.....	13
Base Installation	
• UAS.....	14
• Lap/Shoulder Belt.....	17
• Lap Belt Only.....	20
Attaching & Removing Car Seat.....	23
UAS and Instruction Storage.....	24
Care and Maintenance.....	24
Warranty.....	25

REGISTERING YOUR CHILD RESTRAINT BASE

Please complete the pre-paid registration card that is attached to your child restraint base and send the portion shown below in today or register online at www.babyjogger.ca/carseatregistration.

Fill in block letters, tear off and mail this part		Compléter en lettres majuscules, déchirer et poster cette partie	
REGISTRATION CARD CARTE D'INSCRIPTION			
Your name Votre nom _____			
Your address Votre adresse _____			
City Ville _____		Province Province _____	Postal code Code postal _____
Date of purchase (dd/mm/yy) Date d'achat (jj/mm/aa) _____			
Email address Courriel électronique _____			
To register online go to www.babyjogger.ca Pour registrer en ligne visitez www.babyjogger.ca			
Model / Modèle : _____		Name / Nom : _____	
Brands In Motion Inc., 300 Ambassador Drive Mississauga, Ontario L5T 2J3			
Date of manufacture / Date de fabrication _____ year/année month/mois _____ day/jour			
Serial # / No. de série _____		Fabriqué en Chine	
Made in China			

Child restraints could be recalled for safety reasons. You must register this base to be reached in a recall. Send your name, address, email address if available and the restraint's model number and manufacturing date to:

Brands In Motion Inc.
300 Ambassador Drive
Mississauga, Ontario L5T 2J3
www.babyjogger.ca
or call 1-866-774-7177.

FOR RECALL INFORMATION

For recall information, call the Customer Service in Canada at www.babyjogger.ca or call 1-866-774-7177.

CERTIFICATION

This car seat base meets or exceeds all applicable requirements of Canadian Motor Vehicle Safety Standards 213 and 213.1 for use in motor vehicles. This restraint is certified for use in motor vehicles and aircraft. Use only in forward facing aircraft seats. Follow the instruction in the "Base Installation-Lap Belt Only" section. When installing in an airplane using the base, install the same way as you would in an automobile with the lap belt only. Use the lock-off if possible. If the airplane buckle interferes with the attachment of the seat to base or if you cannot close the lock-off, attach the car seat without the base as shown below. This child restraint can be installed in an airplane with or without the base.

It is not intended to be used in low-speed vehicles such as golf carts, ATV's or any other non-certified vehicles.

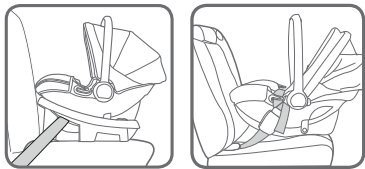

IF YOU NEED ASSISTANCE OR HAVE ANY QUESTIONS

If you have any questions regarding installation of your seat, please contact consumer care:

Brands In Motion Inc.
300 Ambassador Drive
Mississauga, Ontario L5T 2J3
www.babyjogger.ca
or call 1-866-774-7177.

WARNING

WHEN USED IN YOUR VEHICLE

- This restraint system may only be used in these classes of vehicles: passenger cars, multi-purpose passenger vehicles and trucks that have vehicle lap/shoulder belts and tether anchors.



DO NOT place rear-facing child seat on front seat with an active airbag. DEATH OR SERIOUS INJURY can occur. The back seat is the safest place for children 12 and under.

- Only place this child restraint base in a rear-facing direction on a forward facing vehicle seat when using it in a vehicle. NEVER install this base on vehicle seats that face the side or rear of the vehicle.
- Never leave child unattended.
- Read the instructions and labels carefully before using and before installing this base in a vehicle.
- Failure to completely follow the instructions provided in this manual as well as the labels on this product can result in DEATH or SERIOUS INJURY.
- Read your vehicle owner's manual for important information concerning child restraint installation.
- DO NOT ALLOW anyone who has not read the instruction manual to install or use this base.
- Register your base with the manufacturer.
- According to accident statistics, children are safer when properly restrained in rear seating positions, than in the front seating positions.
- Owners of vehicles with airbags should refer to their vehicle owner's manual for child restraint installation instructions.
- Some children with special needs, such as pre-term babies or those who have tested positive for positional apnea, may be at increased risk of suffering breathing or other difficulties in a child restraint.

If your child has special needs, we recommend consulting a physician to determine the proper child restraint for your child before using this product.

- Secure this base with the vehicle's child restraint anchorage system (UAS) if available or with a vehicle belt, never both.
- Never leave a base unsecured in your vehicle, even when unoccupied. An unsecured base can be thrown around and may injure occupants in a sharp turn, sudden stop, or crash.
- To prevent ejection, securely attach the child restraint to the base and lift up to check that it is attached.
- Make sure nothing interferes with the carrier attachment to the base.
- ALWAYS store the UAS connectors when they are not being used for installation.
- NEVER place two UAS connectors on one vehicle UAS anchor.
- DO NOT allow children to play with or around this base.
- Always replace the child restraint and base after a crash of any kind even if it was unoccupied. A crash can cause damage to the child restraint that may not be visible.
- Do not modify your base or use any accessories or parts not supplied by the manufacturer of your child restraint.
- Car seat parts can get very hot in the sun or warm weather. To avoid burns, always check before putting child in car seat.
- NEVER use a base that you do not know its history.
- DISCONTINUE USE of this base after 7 years from the manufacture date. The manufacture date can be found on the top side of your base.
- DO NOT use this base unless your child meets the height and weight criteria for your child restraint.

UAS SYSTEM



UAS stands for Universal Anchor System.

The UAS system can make installation easier without using the vehicle's seat belts. UAS is a way to secure your child restraint base to your vehicle by using the UAS connectors on your child restraint base. These connectors attach to the lower points in certain vehicle seating positions. Refer to your vehicle owner's manual for UAS locations.

The child restraint base is designed to be used at the standard spacing of 28 cm (11") from the center of one anchor point to the center of another anchor point. Please refer to your vehicle owner's manual for information about using UAS in certain seating positions.

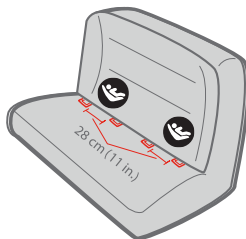

UAS may be used for spacing larger than 28 cm (11") ONLY if your vehicle manufacturer allows it.

If your vehicle does not have lower anchor points, you can still install your child restraint with the vehicle's belt system.

VEHICLE SEAT LOCATIONS

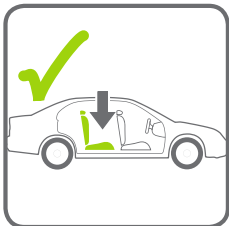

⚠ WARNING!

- Failure to place the child restraint base in the correct seating positions increases the risk of serious injury or death.
- DO NOT place rear-facing child seat on front seat with airbag. DEATH or SERIOUS INJURY can occur.
- The back seat is the safest place for children 12 and under. Owners of vehicles with airbags should refer to their owner's manual for child restraint installation instructions.
- The VEHICLE seat must face forward.
- NEVER place the child restraint base on any vehicle seat that does not lock. Folding seats can fall forward and could cause serious injury to your child in a vehicle crash.



UNSAFE VEHICLE SEAT BELTS

⚠ WARNING! The following types of vehicle seat belts are NOT compatible with this base. If any of the belt types listed are in the chosen seating position, choose another seating position within in the vehicle.



Motorized Shoulder Belt with Lap Belt



Lap or Shoulder Belt Mounted on Vehicle Door



Non-Locking Lap Belts with Emergency Locking Retractor (ELR)



Lap/Shoulder Belts with 2 Retractors (including inflatable seatbelts)

SAFE VEHICLE SEAT BELTS

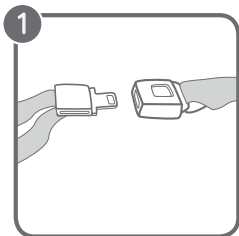

The following vehicle belt systems are SAFE to use for child restraint installation.

1 Lap Belt with Locking Latch Plate - The vehicle belt is tightened by pulling on the free end of the strap until the belt is tight.

2 Lap Belt with Automatic Locking Retractor (ALR)- The automatic locking retractor does not allow the lap belt to get longer once it is buckled. The vehicle belt is tightened by feeding the seat belt webbing into the retractor.

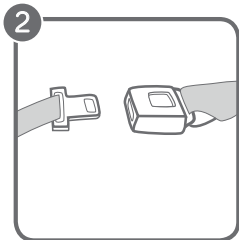

SAFE VEHICLE SEAT BELTS

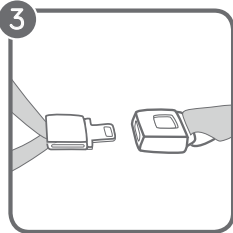

3 Lap/Shoulder Belt with Locking Latch Plate - The lap portion of this belt does not loosen once the belt is buckled. The vehicle belt is tightened by pulling up hard on shoulder belt and feeding the webbing into the retractor.

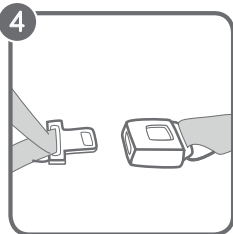

4 Lap/Shoulder Belt with Sliding Latch Plate - The latch plate slides freely along the lap/shoulder belt. Some vehicle belts with sliding latch plates can be locked at the retractor by pulling all of the webbing out slowly to switch the retractor. If it will not lock, review your owners manual. The vehicle belt is tightened after switching the retractor by pulling up hard on shoulder belt and feeding the webbing into the retractor.

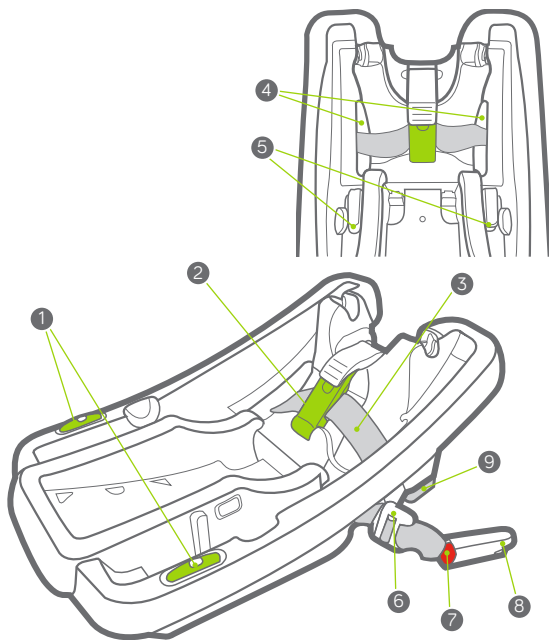

- 1 Level Indicators
- 2 Belt Lock-Off
- 3 UAS Strap
- 4 UAS & Vehicle Belt Path
- 5 UAS Storage Compartment

- 6 UAS Adjuster
- 7 UAS Release Button
- 8 UAS Connector
- 9 Recline Foot

ADJUSTING THE RECLINE

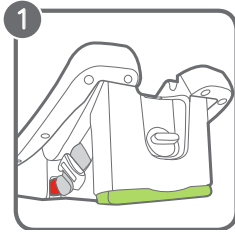

- 1 The base has 6 recline positions for the foot.
- 2 To raise the foot, twist the knob to the left until it clicks into place. Recline base until the bubble rests completely within the blue line.
- 3 Reverse steps to lower the foot.

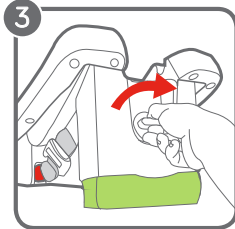
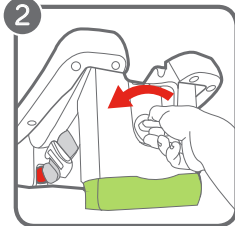

BASE INSTALLATION - UAS

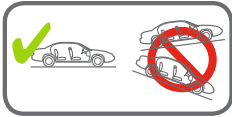

Before installing base, make sure vehicle is on level ground.

Place base on an approved UAS vehicle seating location.

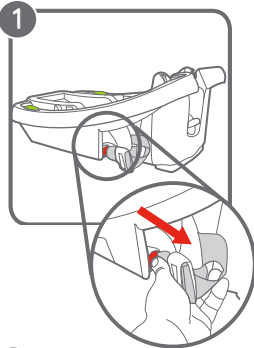

1 Remove UAS strap from UAS storage compartment.

2 Extend the strap to the longest length by pushing in on the gray button and pulling on the strap. Make sure not to twist the belt and make sure it lies flat.

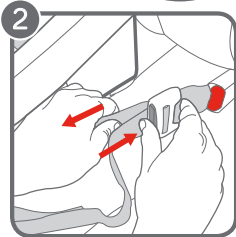

BASE INSTALLATION - UAS

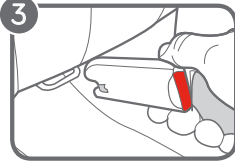

3 Press the UAS connectors onto the adjacent vehicle anchors until a click is heard. Pull the UAS connector to verify a secure lock.

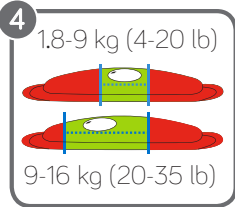

4 Check the level indicator on the base. The bubble must be completely within the zone of your child's weight. For infants weighing 1.8-9 kg (4-20 lb) the bubble must rest within the light blue line. For children weighing 9-16 kg (20-35 lb) the bubble must rest within the dark blue line. Adjust the recline foot if needed.

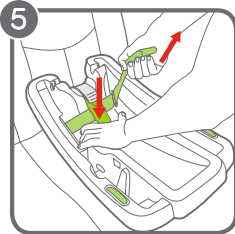

5 While pressing the base down into the seat, pull up on the UAS adjuster strap to tighten. To loosen the UAS adjuster strap, press button on UAS buckle and pull.

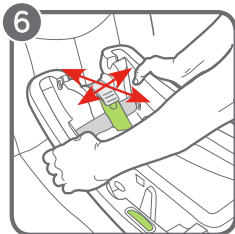

6 Test For Tightness. Grab the sides of the base where the seat belt is and push and pull the base from side to side and front to back. If the base moves less than 2.5 cm (1"), it is tight enough.

BASE INSTALLATION - UAS

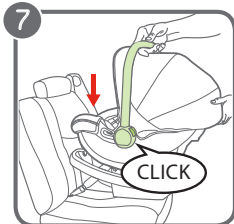

7 Place child restraint into the base. Push down on the front of the child restraint and handle, you will hear a click. Test to make sure it is attached by pulling up on the front corners of the child restraint.

8 Check the level indicator.

Note: If the foot is in the most raised position and the bubble is out of the zone of your child's weight you can place a tightly rolled towel or pool noodle under the front end of the base to achieve the proper recline. The level should be rechecked with child in the seat.

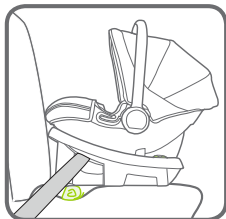
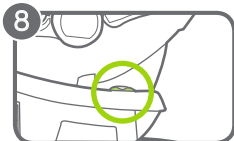

9 To remove base from vehicle seat, push in on the UAS connectors red buttons and remove.

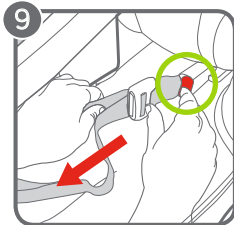

BASE INSTALLATION - LAP/SHOULDER BELT

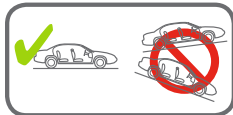

Before installing base, make sure vehicle is on level ground.

Place base on an approved vehicle seat location.

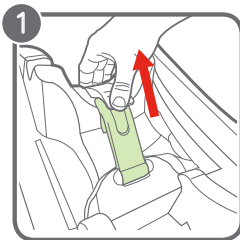

1 Open the lock off.

2 Ensure the vehicle seat belt is not twisted and route the vehicle belt through the first belt path opening then under the belt lock-off and down through the second belt guide.

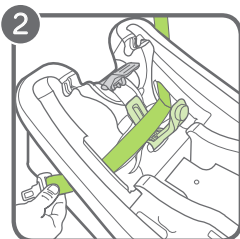

3 Check the level indicator on the base.

The bubble must be completely within the zone of your child's weight. For infants weighing 1.8-9 kg (4-20 lb) the bubble must rest within the light blue line. For children weighing 9-16 kg (20-35 lb) the bubble must rest within the dark blue line. Adjust the recline foot if needed.

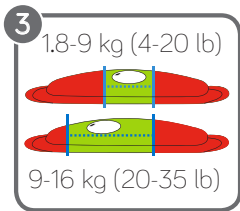

BASE INSTALLATION - LAP/SHOULDER BELT

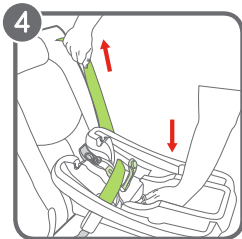

4 While pressing the base down into the seat, pull on the vehicle belt to tighten.

5 Close the lock-off over the lap belt until it clicks into place.

6 Test For Tightness. Grab the sides of the base where the seat belt is and push and pull the base from side to side and front to back. If the base moves less than 2.5 cm (1"), it is tight enough.

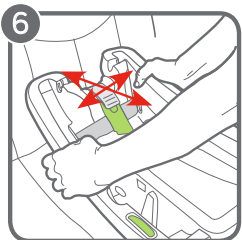
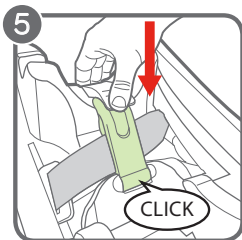

BASE INSTALLATION - LAP/SHOULDER BELT

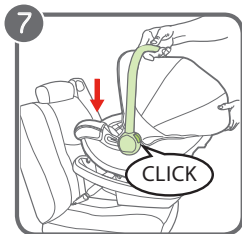

7 Place child restraint into the base. Push down on the front of the child restraint and handle, you will hear a click. Test to make sure it is attached by pulling up on the front corners of the child restraint.



8 Check the level indicator.

Note: If the foot is in the most raised position and the bubble is out of the zone of your child's weight you can place a tightly rolled towel or pool noodle under the front end of the base to achieve the proper recline.

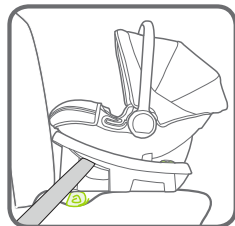

The level should be rechecked with child in the seat.

9 To remove the base, unlock the lock off and unbuckle the seat belt and remove.

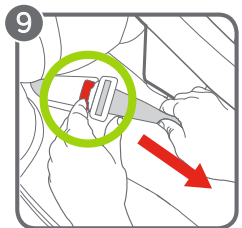

BASE INSTALLATION - LAP BELT ONLY

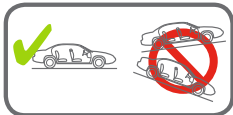

Before installing base, make sure vehicle is on level ground.

Place base on an approved vehicle seat location.

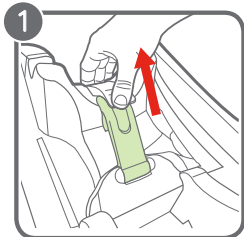

1 Open the lock off.

2 Route the vehicle seat belt through the rear-facing belt path (marked with labels) and buckle. The seat belt should lay flat and not twisted.

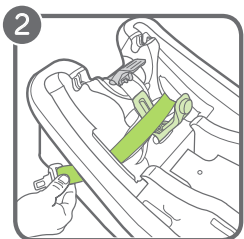

3 Check the level indicator on the base. The bubble must be completely within the zone of your child's weight. For infants weighing 1.8-9 kg (4-20 lb) the bubble must rest within the light blue line. For children weighing 9-16 kg (20-35 lb) the bubble must rest within the dark blue line. Adjust the recline foot if needed.

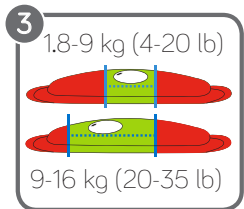

1.8-9 kg (4-20 lb)

9-16 kg (20-35 lb)

BASE INSTALLATION - LAP BELT ONLY

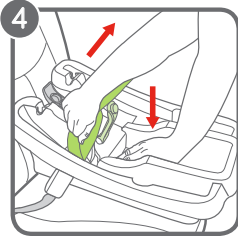

4 While pressing the base down into the seat, pull on the vehicle belt to tighten.

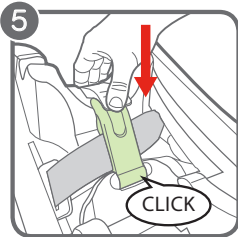

5 Close the lock-off over the lap belt and lock it.

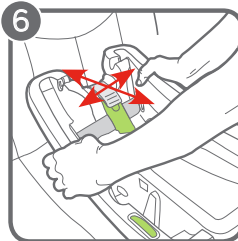

6 Test For Tightness. Grab the sides of the base where the seat belt is and push and pull the base from side to side and front to back. If the base moves less than 2.5 cm (1"), it is tight enough.

BASE INSTALLATION - LAP BELT ONLY

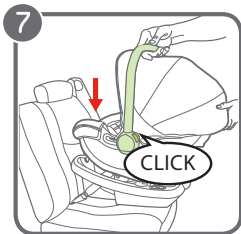

7 Place child restraint into the base. Push down on the front of the child restraint and handle, you will hear a click. Test to make sure it is attached by pulling up on the front corners of the child restraint.

8 Check the level indicator.

Note: If the foot is in the most raised position and the bubble is out of the zone of your child's weight you can place a tightly rolled towel or pool noodle under the front end of the base to achieve the proper recline.

The level should be rechecked with child in the seat.

9 To remove the base, unlock the lock off and unbuckle the seat belt and remove.

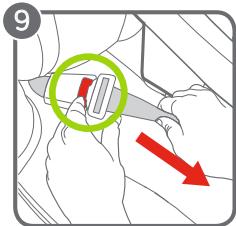
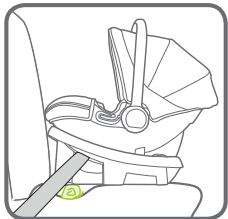
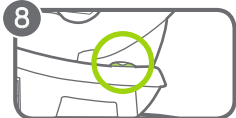

ATTACHING & REMOVING THE CAR SEAT

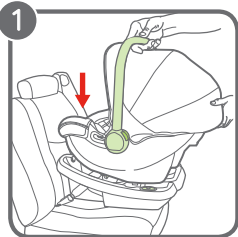

- 1 Attach the carrier into the base until you hear a click. Lift up on the handle of the carrier to make sure that it is securely attached in the base.
- 2 To remove the seat from the base, pull up the release handle located on the rear of the car seat. Lift carrier up.

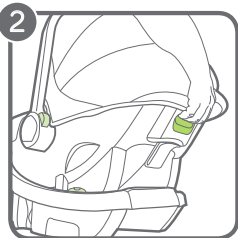

UAS AND INSTRUCTION STORAGE

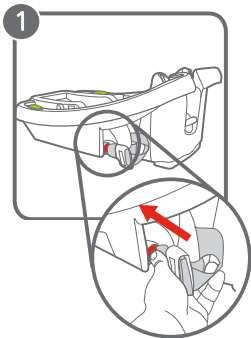

- 1 Press the UAS connectors into the UAS storage compartments until a click is heard.
- 2 Store instruction manual on the under side of the base in the specified grooves in the base.

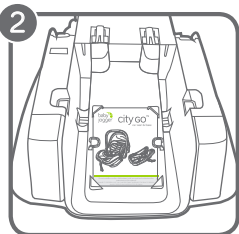

CARE AND MAINTENANCE

Cleaning the Shell:

Spot clean using warm water and mild soap. Do not use any other cleaning agents or bleach.

LIMITED WARRANTY

This product is warranted against defective materials or workmanship for one year from the date of original purchase. Proof of purchase is required.

The warranty does not include:

- Normal wear and tear
- Corrosion or rust
- Incorrect assembly or the installation of third party parts or accessories not compatible with the original design.
- Accidental or intentional damage, abuse, or neglect.
- Commercial Use
- Improper storage/care of the unit

This warranty specifically excludes claims for indirect, incidental, or consequential damages. The implied warranties of merchantability and fitness for a particular purpose is according to the specific warranty period for this model unit at time of purchase.

Some states do not allow the exclusion or limitation of incidental or consequential damages, so the above limitations or exclusions may not apply to you. This warranty gives you specific legal rights and you may also have other rights which vary from state to state. To know what your legal rights are in your state, consult your local or state consumer affairs office or your state's Attorney General.

Note: When contacting Baby Jogger regarding your product, please have the serial number and manufacturing date ready. It can be found on the underside of the car seat and inside of the base.

Canadian Customer Care Contact Information:

E-Mail: info@babyjogger.ca
Call: 1-866-774-7177
Fax: 905-795-8988
Mail: Brands In Motion Inc.
300 Ambassador Drive
Mississauga, Ontario L5T 2J3
www.babyjogger.ca



Notes:

Notes:



Baby Jogger, LLC

Brands In Motion Inc. • 300 Ambassador Drive • Mississauga, Ontario L5T 2J3
1-866-774-7177 • www.babyjogger.ca